

Mass Decontamination Unit



Lightweight and quick to deploy, the inflatable Mass Decontamination Unit from MFC Survival allow for rapid response in a decontamination situation.

- Lightweight and easily portable
- Will be set up within a matter of minutes and will stay standing without continuous inflation
- The Mass decontamination unit is internally partitioned into three lanes with pre and post decon changing rooms
- Optional raised floor panels prevent contact with contaminated shower wash off which is collected in a chemically resistant sump
- Sleeves for pumped extraction of contaminated water are included as standard
- Can be used on hard or soft standing and guy ropes are provided for securing in position
- Minimal training, servicing and maintenance costs

Used For:

- Decontamination scenarios

	TECH DATA
Product Code	DS0026
Length (cm)	750
Int. Length (cm)	730
Width (cm)	470
Int. Width (cm)	410
Height (cm)	290
Int. Height (cm)	260
Int. Floor Area (sq.m)	30
Air Requirements (ltr)	3800
Max. Water inlet pressure (bar)	3
Recommended pump flow-capacity (ltrs)	10/minute per nozzle
Pack size (cm)	160x80x60
Weight (kg)	90
Number of Shower Nozzles	12
Number of Shower hose connectors	4
Number of Shower Brush Connectors	2
Number of Heater sleeves	2
Number of Cable sleeves	6



Mass Decontamination Unit

Standard Equipment

Windows C/w Blind
(SH9111)



Internal Shower Nozzle (x12)
(Part of shower hose assembly)



Shower Hose Assembly x4
(DS9029)



Shower hose connector x4
(Part of shower hose assembly)



Guy Lines
(SH9110)



D7 Inflate/Deflate Valve
(050065)

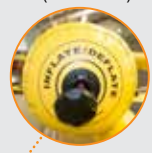

A6 Relief valve
(050051)

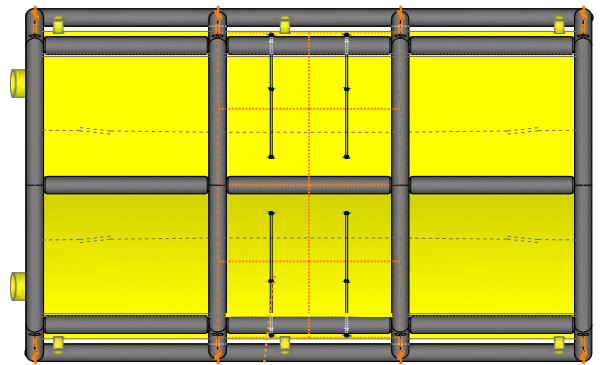
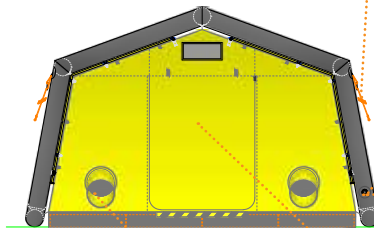
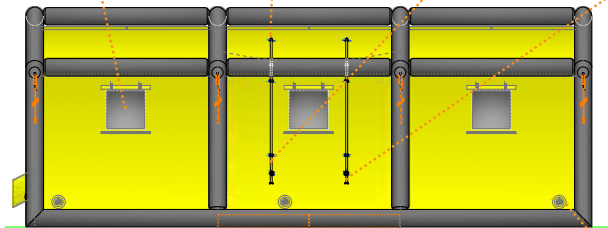

Water/Waste Water Sleeve
(SH9075)



Heater Sleeve
(SH9074)



Door



Internal Shower Brush Connector (x4)
(010406)



Repair Kit
(600003)



1m Delivery Hose (for use with 8 bar regulator)
(HS-03-04-01-09-17)



Valise
(590016)

Optional Equipment



Lettering/Logos Dacron



Pallets x8
(140018)



Hand Brush Assembly
(DS9050)



8 Bar Regulator
(RE0034)



Bravo2000 Electric Inflator
(180026)



Clean Water Tank
(WS0028)



Waste Water Tank
(WS0017)



Dosatron Detergent Dispenser
(180023)



Inlet Water Pump
(180022)



Outlet Water Pump
(180021)

Mass Decontamination Unit

The Diagram below shows the different compartments of the Mass Decontamination shelter. It also shows how the user enters the decontamination shelter and shows the direction of where to go. The areas are colour coded:

- Red- this is to show that the area will be contaminated so this is where the user will enter the unit
- Yellow- this shows the area where the user will wash off any contamination
- Green - this shows that the area is clean and decontaminated

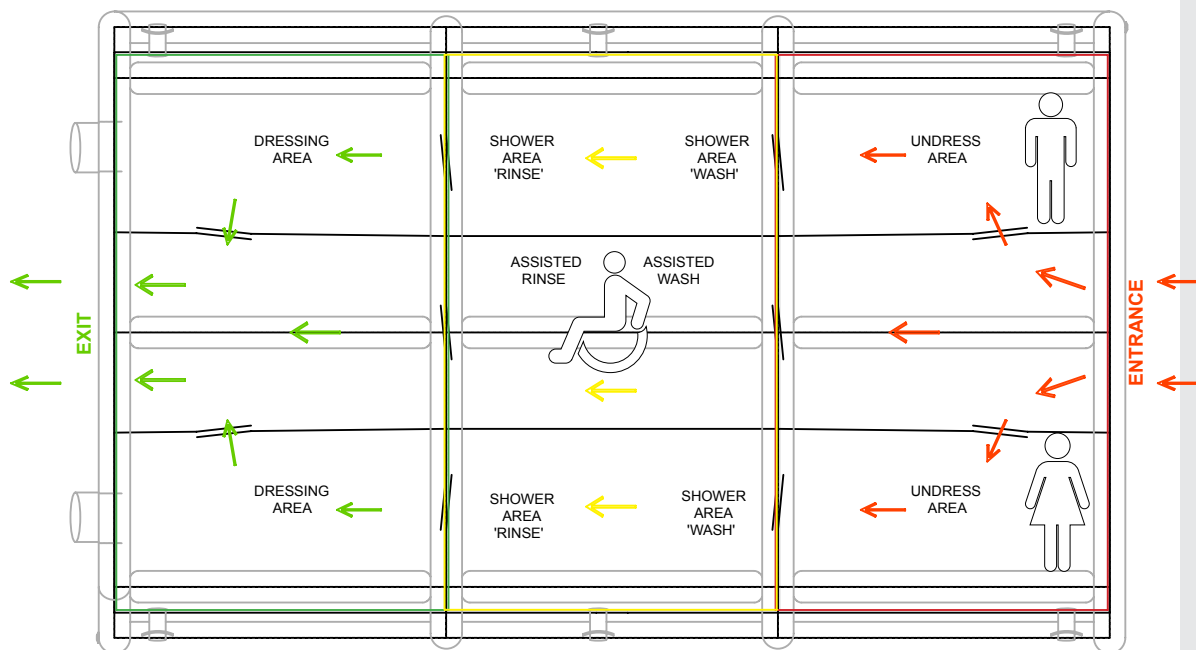

MFC International
Naval Yard
Tonypandy
Rhondda Cynon Taff
CF40 1JS

☎: +44 (0) 1443 433 075
✉: sales@mfc-international.com
🌐: www.mfc-international.com